

## Series 4030 End Suction Base Mounted

# 4 x 3 x 10

## SUBMITTAL

JOB: _____	REPRESENTATIVE: _____
_____	_____
ENGINEER: _____	ORDER NO: _____ DATE: _____
CONTRACTOR: _____	SUBMITTED BY: _____ DATE: _____
_____	APPROVED BY: _____ DATE: _____

PUMP DESIGN DATA			
NO. OF PUMPS:	TAG:		
CAPACITY:	m <sup>3</sup> /h (L/s)	HEAD:	m (ft)
LIQUID:	VISCOSITY:		
TEMPERATURE:	°C (°F)	SPECIFIC GRAVITY:	
SUCTION: 100 mm (4") Flanged	DISCHARGE: 75 mm (3") Flanged		

MOTOR DESIGN DATA	
HP:	RPM:
FRAME SIZE:	ENCLOSURE:
VOLTS:	HERTZ: 50 Hz PHASE:
EFFICIENCY*: <input type="checkbox"/> NEMA Premium (12.12) <input type="checkbox"/> Other _____%	

\*Fractional power & Frame 56 motors are supplied with the standard efficiency of the manufacturer.

MATERIALS OF CONSTRUCTION				
ANSI FLANGE RATING	<input type="checkbox"/> ANSI 125		<input type="checkbox"/> ANSI 250	
CONSTRUCTION	<input type="checkbox"/> BF	<input type="checkbox"/> AI	<input type="checkbox"/> BF	<input type="checkbox"/> AI
IMPELLER	BRONZE	CAST IRON	BRONZE	CAST IRON
CASING	CAST IRON		DUCTILE IRON	
GASKET	CONFINED NON-ASBESTOS FIBER			
BEARING FRAME	CAST IRON			
ANTI-FRICTION BEARINGS	PERMANENTLY LUBRICATED*			
SHAFT	CARBON STEEL			
SHAFT SLEEVE	STAINLESS STEEL			
COUPLER	WOODS SURE FLEX OR EQUAL			
COUPLER GUARD	STEEL OSHA			
BASEPLATE	FABRICATED STEEL			
MAX. PUMP OPERATING CONDITIONS	12 bars at 66°C (175 psig at 150°F)		20 bars at 65°C (300 psig at 150°F)	
	10 bars at 121°C (140 psig at 250°F)		14 bars at 121°C (210 psig at 250°F)	

- TOLERANCE OF ±3 mm (±0.125") SHOULD BE USED
- FOR EXACT INSTALLATION DATA PLEASE WRITE FACTORY FOR CERTIFIED DIMENSIONS
- SEE PERFORMANCE CURVES ON PAGE 2
- PUMP EQUIPPED WITH CASING DRAIN PLUG AND 1/4" NPT SUCTION AND DISCHARGE GAUGE PORTS

MECHANICAL SEAL DESIGN DATA		
FLUID TYPE	NON-POTABLE	POTABLE (DRINKING) WATER
SEAL TYPE	2A	
ROTATING FACE	ANTIMONY LOADED CARBON	RESIN BONDED CARBON
STATIONARY SEAT	SILICON CARBIDE	
SECONDARY SEAL	VITON	EPDM
SPRING	STAINLESS STEEL	
ROTATING HARDWARE	STAINLESS STEEL	

### OPTIONAL EQUIPMENT

FOR PERFORMANCE CURVES SEE PAGE 2

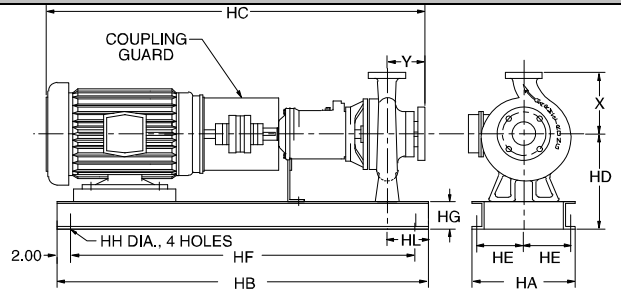

MOTOR HORSEPOWER					MAX. DIMENSIONS mm (inches)											MAX. ASSEMBLY WEIGHT*
ODP		TEFC		FRAME	ODP / TEFC											kg (lbs.)
3000	1500	3000	1500		HA	HB	HC	HD	HE	HF	HG	HH	HL	X	Y	
---	3	---	3	182T	356 (14.00)	762 (30.00)	768 (30.22)	286 (11.25)	162 (6.38)	660 (26.00)	76 (3.00)	19 (0.75)	114 (4.50)	279 (11.00)	102 (4.00)	95.8 (211)
---	5	---	5	184T	356 (14.00)	762 (30.00)	768 (30.22)	286 (11.25)	162 (6.38)	660 (26.00)	76 (3.00)	19 (0.75)	114 (4.50)	279 (11.00)	102 (4.00)	100.3 (221)
---	7.5	---	7.5	213T	356 (14.00)	838 (33.00)	862 (33.92)	286 (11.25)	162 (6.38)	737 (29.00)	76 (3.00)	19 (0.75)	114 (4.50)	279 (11.00)	102 (4.00)	116.2 (256)
---	10	---	10	215T	356 (14.00)	838 (33.00)	862 (33.92)	286 (11.25)	162 (6.38)	737 (29.00)	76 (3.00)	19 (0.75)	114 (4.50)	279 (11.00)	102 (4.00)	123.0 (271)
25	---	---	---	256T	406 (16.00)	1016 (40.00)	1012 (39.86)	286 (11.25)	187 (7.38)	914 (36.00)	76 (3.00)	19 (0.75)	114 (4.50)	279 (11.00)	102 (4.00)	141.2 (311)
30	---	25	---	284TS†	483 (19.00)	1219 (48.00)	1143 (45.01)	311 (12.25)	225 (8.88)	1118 (44.00)	102 (4.00)	19 (0.75)	114 (4.50)	279 (11.00)	102 (4.00)	195.7 (431)
40	---	30	---	286TS†	483 (19.00)	1219 (48.00)	1143 (45.01)	311 (12.25)	225 (8.88)	1118 (44.00)	102 (4.00)	19 (0.75)	114 (4.50)	279 (11.00)	102 (4.00)	227.5 (501)
50	---	40	---	324TS†	483 (19.00)	1219 (48.00)	1217 (47.92)	311 (12.25)	225 (8.88)	1118 (44.00)	102 (4.00)	19 (0.75)	114 (4.50)	279 (11.00)	102 (4.00)	331.9 (731)
60	---	50	---	326TS†	483 (19.00)	1219 (48.00)	1217 (47.92)	311 (12.25)	225 (8.88)	1118 (44.00)	102 (4.00)	19 (0.75)	114 (4.50)	279 (11.00)	102 (4.00)	368.2 (811)
---	---	60	---	364TS†	483 (19.00)	1219 (48.00)	1258 (49.51)	368 (14.50)	225 (8.88)	1118 (44.00)	102 (4.00)	19 (0.75)	114 (4.50)	279 (11.00)	102 (4.00)	418.1 (921)

\*Assembly weight combines pump and motor.

†Re-greaseable ball bearings on pumps for frame sizes indicated.

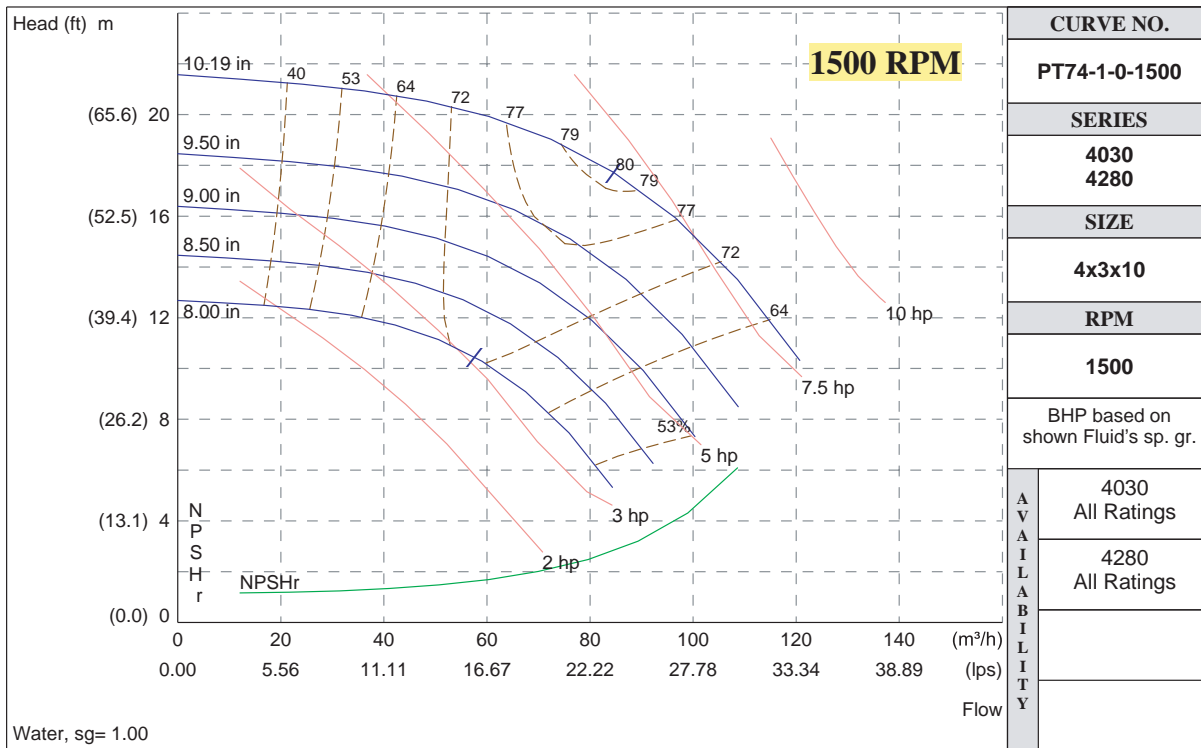
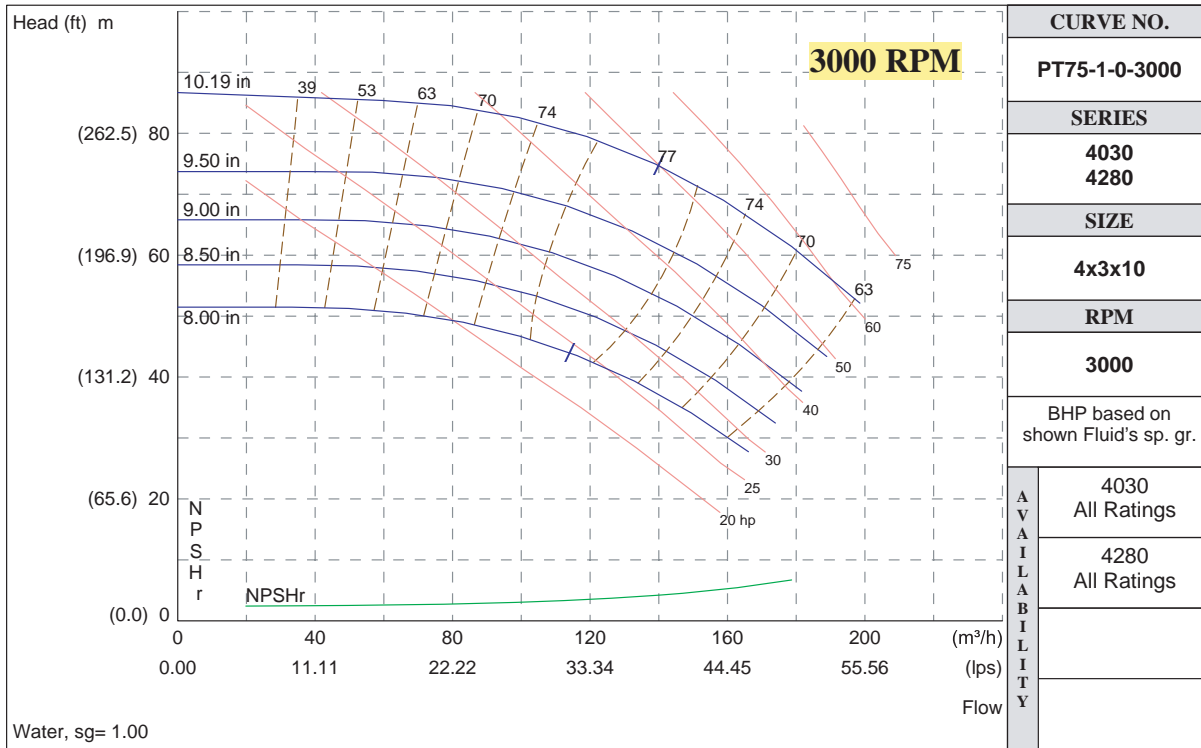

Armstrong Integrated Limited  
 Wenlock Way  
 Manchester  
 United Kingdom, M12 5JL  
 T: +44 (0) 8444 145 145  
 F: +44 (0) 8444 145 146

S. A. Armstrong Limited  
 23 Bertrand Avenue  
 Toronto, Ontario  
 Canada, M1L 2P3  
 T: 416-755-2291  
 F: 416-759-9101



© S.A. Armstrong Limited 2011