

## Vertical Multistage Pumps

## VMS 2 B - 2 pole - DIN

## SUBMITTAL

JOB: _____	REPRESENTATIVE: _____
_____	_____
ENGINEER: _____	ORDER NO: _____ DATE: _____
CONTRACTOR: _____	SUBMITTED BY: _____ DATE: _____
	APPROVED BY: _____ DATE: _____

### VM Closed coupled motor Construction type; IM 3619

CONNECTION	MIN. PRESSURE CLASS OPTIONS	MOTOR DIMENSIONS			VMS(S)-/E/V/T		VMS(C/S)F		UNIT WEIGHT
		kW	E1	E2	F1	F1	KG		
2/2	PN10	0.37	138	109	420	445			17.6
2/3		0.37	138	109	441	466			18.0
2/4		0.37	138	109	463	488			18.4
2/5		0.37	138	109	484	509			18.8
2/6		0.55	138	109	506	531			19.4

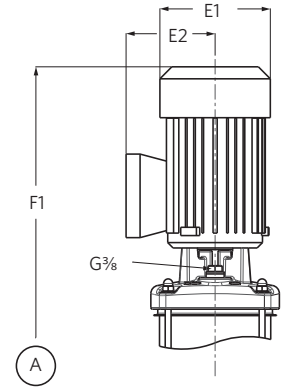

### V Long coupled motor Construction type; V18

CONNECTION	MIN. PRESSURE CLASS OPTIONS	MOTOR DIMENSIONS			VMS(S)-/E/V/T		VMS(C/S)F		UNIT WEIGHT
		kW	E1	E2	F1	F2	F1	F2	
2/2	PN10	0.37	138	109	472	259	497	284	17.6
2/3		0.37	138	109	493	280	518	305	18.0
2/4		0.37	138	109	515	302	540	327	18.4
2/5		0.37	138	109	536	323	561	348	18.8
2/6		0.55	138	109	558	345	583	370	19.4
2/7		0.55	138	109	579	366	604	391	19.8
2/8		0.55	138	109	601	398	626	423	20.2
2/9		0.75	160	150	676	419	701	444	26.8
2/10		0.75	160	150	698	441	723	466	27.3
2/11		1.10	160	150	719	462	744	487	27.7
2/12		1.10	160	150	741	484	766	509	28.1
2/14		PN16	1.10	160	150	784	527	809	552
2/16	1.50		185	160	833	580	858	605	35.6
2/18	1.50		185	160	876	623	901	648	36.5
2/20	PN25 PN40	1.50	185	160	919	666	944	691	37.3
2/22		2.20	185	160	991	709	1016	734	44.8
2/24		2.20	185	160	1034	752	1059	777	45.6
2/26		2.20	185	160	1077	795	1102	820	46.5
2/28		2.20	185	160	1120	838	1145	863	47.3
2/30		2.20	185	160	1163	881	1188	906	63.6

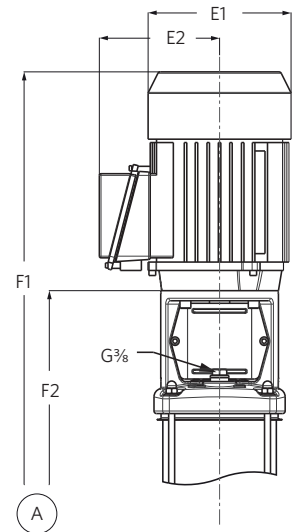

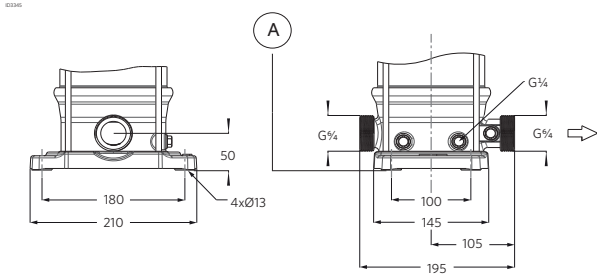

### VMS E Male thread -

With non return valve insert at discharge side and pressure measurement plug at upstream side  
 Norm: G EN ISO 228  
 Size: G F/d  
 Pressure Class: PN16  
 Option: Base plate in Cast SS 1.4308

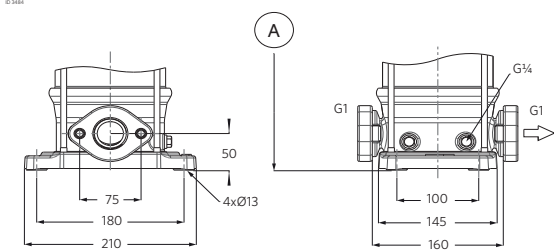

### VMS (S)

Counter flange with female thread included  
 VMS: Cataphoric coated cast iron  
 VMSS: Cast Stainless steel 1.4408  
 Norm: G EN ISO 228  
 Size: G1  
 Pressure Class: PN16  
 Option: SS 1.4308 flange and base plate

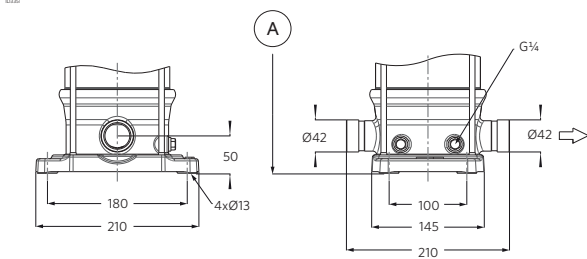

### VMS (S) V Victaulic

Norm: - Size: 42.2  
 Pressure Class: PN25  
 Option: Base plate in cast SS 1.4308

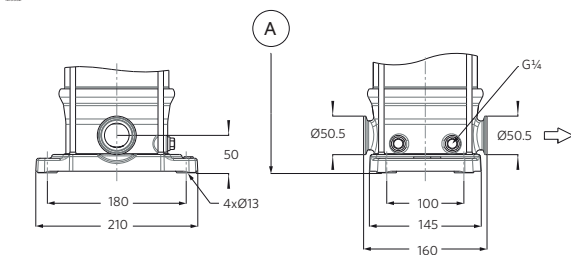

### VMS S T Tri-Clamp

Norm: 32676  
 Size: DN32  
 Pressure Class: PN16  
 Option: Base plate in cast SS 1.4308

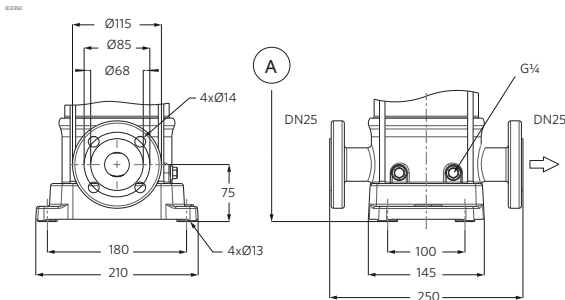

### VMS C F Cast Iron Flange

Norm: EN 1092-1/1092-2  
 Size: NW25  
 Pressure Class: PN40

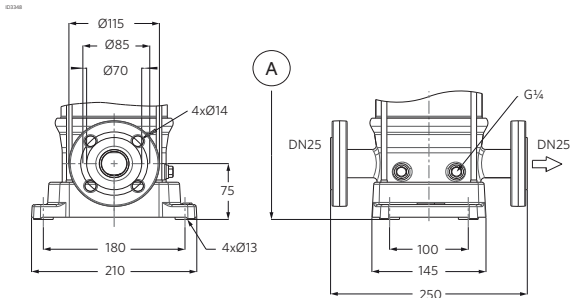

### VMS (S) F Round collar flange

Cataphoric coated collar flange  
 Norm: EN 1092-1/1092-2  
 Size: NW25  
 Pressure Class: PN40  
 Option: Collar flange and/or base plate in cast SS 1.4308

#### ARMSTRONG INTEGRATED LIMITED

Wenlock Way  
 Manchester  
 United Kingdom, M12 5JL  
**T:** +44 (0) 8444 145 145  
**F:** +44 (0) 8444 145 146

#### S. A. ARMSTRONG LIMITED

23 Bertrand Avenue  
 Toronto, Ontario  
 Canada, M1L 2P3  
**T:** 416 755 2291  
**F:** 416 759 9101